

## wall mounting socket outlet - housing dimensions 100x75



Product description	
BALS-Prd.-Nr	11307
EAN	4024941113076
Product group	Wall mounting socket outlet
Current	16A
Number of poles	4p
Arrangement of the phases	3P+PE
Earth 'clock' position	6 h
Voltage	380 up to 415V
Frequency	50 and 60Hz

Product description	
Protection degree	IP67
Colour code	red
Colour of appliance	Hinged lid red, Bayonet ring grey, Housing bottom grey, Housing top grey
Connection design	screw terminal
Maximum conductor size	4,0 qmm
Cable entry	1x Top entry M20 1x Bottom entry
Dimension of enclosure	100x75 mm (HxW)
Material of enclosure	Polyamide
Contacts	The contact carrier is made of polyamide, The contacts are brass

Additional technical information	
	The cable entry is one at top open and one at bottom and one rear side closed
	Lower part of housing rotatable by 180°

Logistics data	
Weight/pcs	0.26 kg / piece
Packaging	bag
Content amount	1 ST
EAN	4024941113076
Length	410 mm
Width	285 mm

Logistics data	
Weight	0.26 kg
Packaging	carton
Content amount	10 ST
EAN	4024941819640
Length	387 mm
Width	222 mm
Height	150 mm
Weight	2.793 kg
Volume	11,029.5 ccm

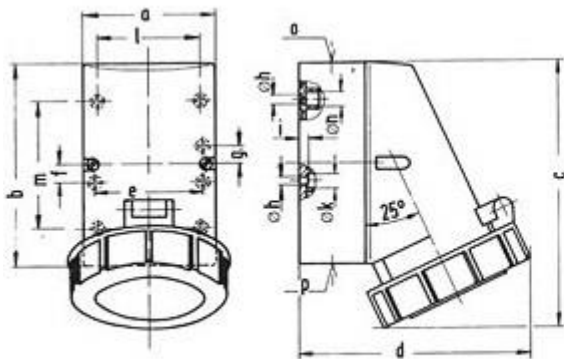

Amperes	16			32		
Poles	3	4	5	3	4	5
a	64	75	75	83	83	83
b	87	100	100	126	126	126
c	115	130	130	160	160	160
d	103	110	115	129	129	135
e	51	59	59	68	68	68
f	20	11	11	11	11	11
g	20	-	-	-	-	-
øh	4.1	5.1	5.1	5.5	5.5	5.5
i	4.5	4.5	4.5	6.5	6.5	6.5
øk	8	10	10	12	12	12
l	-	-	-	65	65	65
m	-	-	-	80	80	80
ø n	-	-	-	10	10	10
o	M20	M20	M20	M25	M25	M25
p	M20	M20	M20	2xM25	2xM25	2xM25
Conductor mm <sup>2</sup> min	1.5	1.5	1.5	2.5	2.5	2.5
Conductor mm <sup>2</sup> max	4	4	4	10	10	10